

PARTS FOR SIMPLEX TYPE N 01/11/21/22

ART. NO. 778344PTFE

Net weight: 0,082 kg

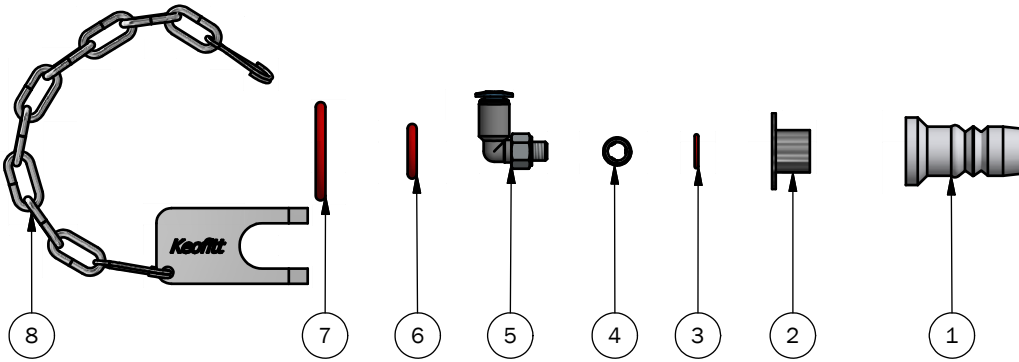

PART LIST

ITEM	QTY	PART NUMBER	TITLE	MATERIAL
1	1	850055	MEMBRANE W9/SIMPLEX PTFE	PTFE White (TFM 1600)
2	1	830149	BUSHING FOR SIMPLEX	AISI 303 (1.4305)
3	1	830825	10 PACK O-RING 7,00x1,00 SILICONE (FDA)	Silicone (red)
4	1	550184	10 PACK O-RING FESTO SCREW	AISI 316L (W1.4404)
5	1	600838	SWIVEL ELBOW F/ ACTUATOR OD 4 MM	Zinc
6	1	800830	10 PACK O-RING 10,3 x 2,4 SILICONE FDA	Silicone (red)
7	1	300119	10 PACK O-RING 20,24 x 2,62 FDA	Silicone (red)
8	1	600255	TOOL FOR MEMBRANE W9 (PTFE)	