





## VALVE HEAD M4 TYPE K. PTFE





ART. NO. 405542

### GENERAL

-  The KEOFITT CLASSIC M4 Sampling Valve is the smallest KEOFITT sampling valve. Numerous standard process connections, membranes and valve heads allow for +120 M4 valve configurations. Unique serial number engraved in each valve ("E" = internal electro)
-  The sampling valve can be used for any process sampling for microbiological, chemical and/or physical analysis.
-  Cleaning/sterilizing: Between batches: Valve in open position: Cleanable by means of CIP using the detergent solution suitable for the actual process media (EHEDG certificate available). Between samples: Valve in its normal closed position: cleanable by CIP as "Between batches" or the valve may be sterilized by means of steam SIP (EHEDG test report available) or chemical SIP using a procedure appropriate to the actual circumstances. For further advice, please contact Keofitt.
-  Designed for sampling of liquids with a viscosity of up to approx. 100 cP containing no particles larger than Ø1,5 mm. Sampling of more viscous liquids is possible, only will it take longer (depending on process pressure).
-  To be used with key ring handle item #400076 (not included as one may serve several valves).



### FEATURES

-  Installation: Threaded socket connection M16x1
-  Operation: Key ring handle
-  Inlet / Outlet: Depending on choice of valve body
-  Membrane: PTFE (TFM 1600 - white)

### CERTIFICATION\*

· Conforms to 3-A · EHEDG CIP · EU 1935/2004

### TECHNICAL DATA

#### Material (product contact)

· Membrane PTFE (TFM 1600 - white)

#### Material (without product contact)

· Steel parts AISI 303L (1.4305)  
· Steel parts AISI 316L (1.4404)

#### Membrane

· Article PTFE, WHITE (# 400055)  
· Certification\* FDA · USP · EU 1935/2004

#### Pressure & Temperature

· Pressure 0 - 6 bar (g) / 0 - 87 psi (g)  
· Temperature 1 - 150 °C / 34 - 302 ° F  
· Air supply -

#### Net Weight







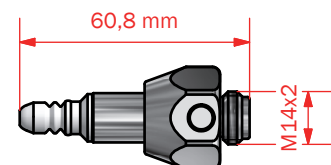
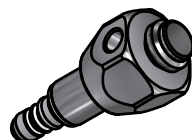
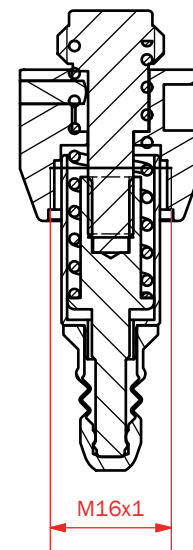

· Kg/lbs 0,085 kg / 0,19 lbs

#### Spareparts

774041PTFE PARTS FOR M4 HEAD 405541/42/43/47



**M 4 BODIES**

		<b>Connection bodies</b>					<b>Welding bodies</b>				
		Thread	Clamp 1"	Mini Clamp	Varivent Ø68	Varivent Ø50	Pipe Welding	Pipe Welding 1"	Tank Welding		
		 400031	 400022	 400021	 400009	 400010	 400014	 400011	 400001	Hose Piece	Mini Tri-Clamp
		Not available	Not available	Not available	Not available	Not available	Not available	Not available	Not available		
		Not available	Not available	Not available	Not available	Not available	Not available	Not available	Not available		Thread M12x0,75