





# VALVE BODY M4 TYPE C 1" 4539

ART. NO. 400022.3

## GENERAL

-  The KEOFIT CLASSIC M4 Sampling Valve is the smallest KEOFIT sampling valve. Numerous standard process connections, membranes and valve heads allow for +120 M4 valve configurations.
-  The sampling valve can be used for any process sampling for microbiological, chemical and/or physical analysis.
-  The valve can be sterilized by means of SIP (EHEDG test) and cleaned by means of CIP (EHEDG certified).
-  The product to be sampled should have a maximum viscosity of 0-100 cP and should not contain particles larger than 1,5 mm diameter.



## FEATURES

-  Installation: Clamp connection 1"/NA
-  Operation: Depending on choice of valve head
-  Inlet / Outlet: Hose piece
-  Membrane: Depending on choice of valve head

## CERTIFICATION\*

· EHEDG CIP · Conforms to 3-A · 3.1 Material Certificate · EU 1935/2004 · RA certificate

## TECHNICAL DATA

### Material (product contact)

- Steel parts                      AISI 904L (1.4539) ON REQUEST

### Material (without product contact)

- Steel parts                      AISI 316L (1.4404)
- Rubber cap                      EPDM (black)
- Stainless steel chain            AISI 316L (1.4404)

### Surface Treatment

- Outside                          Electropolished Ra <= 1.2 µm
- Inside                            Ra <= 0.5 µm
- Process connection

### Pressure & Temperature

- Pressure                          Depending on choice of valve head
- Temperature                    Depending on choice of valve head
- Air supply

### Net Weight







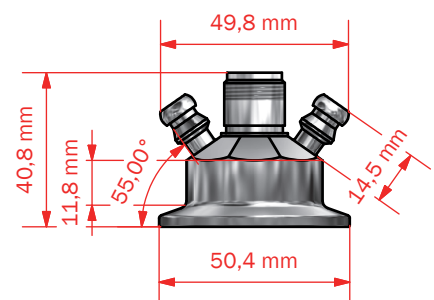
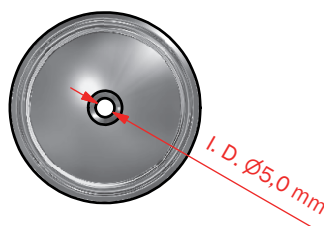
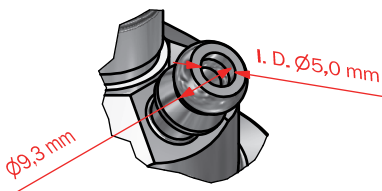
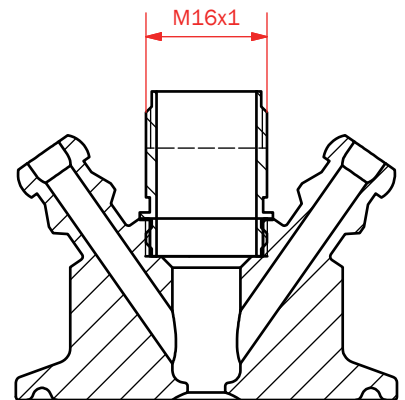

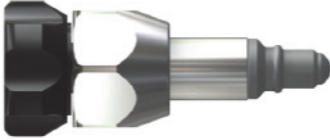

- Kg/lbs                              0,221 kg /0,48 lbs

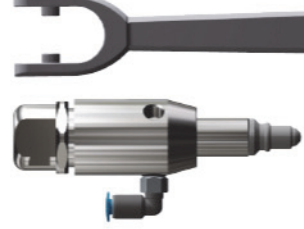
### Spareparts

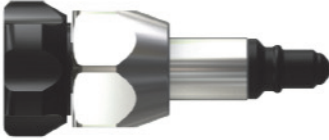
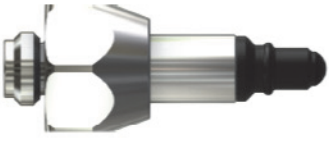
- 774001                              PARTS FOR M4 BODY 400001/11/14/21/22

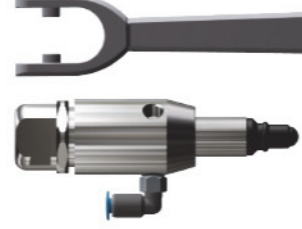

# M 4 HEADS

	<p><b>Silicone</b> 0 °C to +150 °C</p>	<p><b>Type H</b> Turn knob 0-6 bar (g)</p>  <p>400041</p>	<p><b>Type K</b> Key ring 0-6 bar (g)</p>  <p>400042</p>	<p><b>Key Ring</b> for valve head</p>  <p>400076</p>	<p><b>Type Q</b> Lever handle 0-6 bar (g)</p>  <p>400043</p>	<p><b>Type N</b> Pneumatic 0-6 bar (g)</p>  <p>400044</p>	<p><b>Type B</b> No spring 0-12 bar (g)</p>  <p>400047</p>
<p><b>EPDM</b> 0 °C to +130 °C</p>	<p>400041E</p> 	<p>400042E</p> 	<p>400076</p> 	<p>400043E</p> 	<p>400044E</p> 	<p>400047E</p> 	
<p><b>PTFE</b> 0 °C to +130 °C</p>	<p>405541</p> 	<p>405542</p> 	<p>400076</p> 	<p>405543</p> 	<p>405544</p> 	<p>405547</p> 