





## MEMBRANE I52 PTFE

ART. NO. 320055

### GENERAL

-  KEOFITT has the widest selection of spare parts and accessories to complete your sampling system
-  Compatible with all KEOFITT I52 valve heads with PTFE membrane
-  The patented membrane design is an essential part of the hygienic design of the KEOFITT sampling valves
-  It allows for optimal exposure to CIP and SIP media while also integrating the capacity to remove the membrane from the valve body without the use of tools



### FEATURES

-  Compatible with all KEOFITT I52 valve heads with PTFE membrane

### CERTIFICATION\*

FDA · USP · EU 1935/2004

### TECHNICAL DATA

Material:	PTFE (TFM 1600 - white)
Range of temperature in dry atmospheric air:	-200° - +200°C / -328° - +392°
Ball hardness (N/mm <sup>2</sup> ):	29
Tensile strength (DIN53455 - N/mm <sup>2</sup> ):	35
Elongation at break (DIN53455 - %):	350
Density (DIN 53479 - g/cm <sup>3</sup> ):	2,17
Shore D (DIN 53505):	57
Thermal conductivity (W/m.k DIN 52612):	0,22
Expansion coefficient (DIN 53752 [K <sup>-1</sup> ]):	12-17x10 <sup>-5</sup>
Flammability:	Inflammable UL 94
Chemical resistance:	Is not attacked by common chemicals with the exception of strongly oxidising acids

### LIFE TIME

Average life time of a PTFE membrane is 12 months - to be determined by user.

Temp. max.:	1 - 150° C / 34 - 302° F
Steam pressure:	0 - 2 bar (g) / 0 - 29 psi (g)
Process pressure:	0 - 6 bar (g) / 0 - 87 psi (g)
CIP:	NaOH or similar

### Net Weight

· Kg/lbs	0,011 kg / 0,02 lbs
----------	---------------------

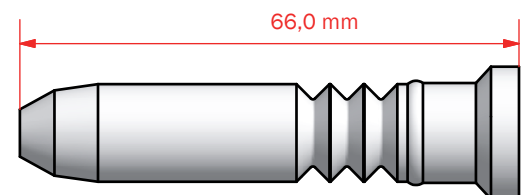
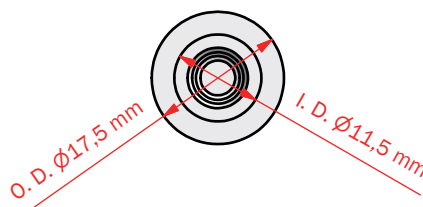
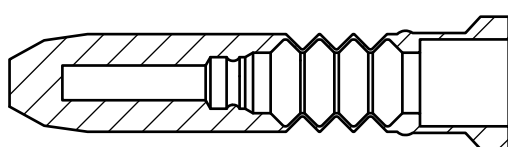

# MEMBRANES INGOLD 52 MM

Silicone	EPDM	PTFE
 320051	 320052	 320055

## Part of valve head

320041	320041E	325541
320043	320043E	325543
320044	320044E	325544

## Part of spare part kit

773241	773241EPDM	773241PTFE
773244	773244EPDM	773244PTFE